

## Package Dimensions

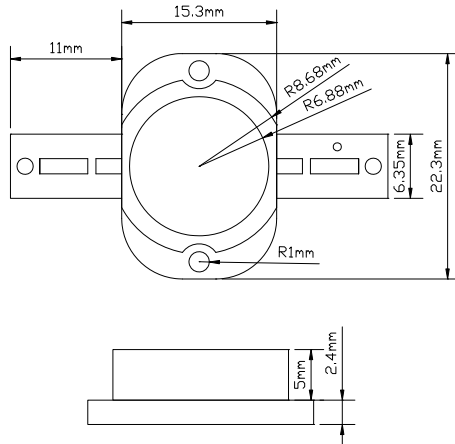

## Material's Picture



## Notes

1. All dimensions are in millimeters (inches).
2. Tolerance is  $\pm 0.25\text{mm}$  (0.010") unless otherwise noted.
3. Protruded resin under flange is 1.0mm (0.04") max.
4. Lead spacing is measured where the leads emerge from the package.
5. Specifications are subject to change without notice.

## Spatial Distribution

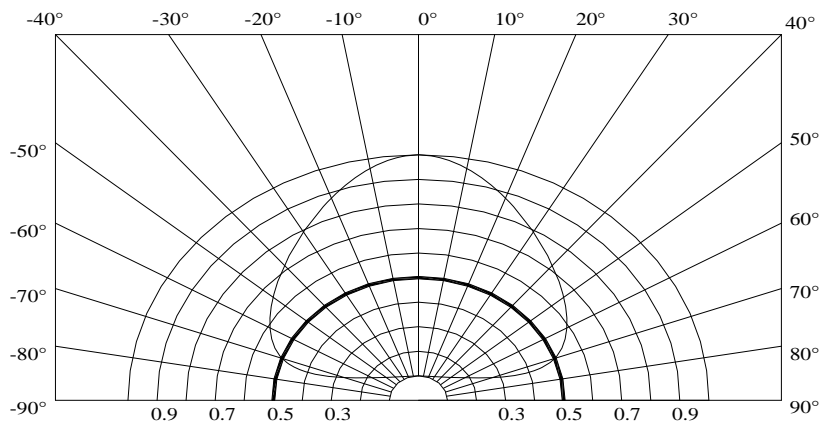

PART NUMBER	REV	PAGE	DATE
WX-P20WW649B10800	R101	1/4	2009-11-27

## Electrical / Optical Characteristics at TA=25°C

Parameter	Symbol	Min.	Typ.	Max.	Unit	Test Condition
Luminous Intensity	$\Phi$	800	850	900	lm	IF =900mA
Viewing Angle	$2\theta 1/2$		140		deg	IF =900mA
Domain Wavelength	Tc	6000	6500	7000	K	IF =900mA
Spectral Line Half-Width	$\Delta \lambda$				nm	IF =900mA
Forward Voltage	VF	10,00	10,50	11,00	V	IF =900mA
Reverse Current	IR			20	$\mu A$	VR = 5V

## Absolute Maximum Ratings at TA=25°C

Parameter	Maximum Rating
Power Dissipation	10W
Peak Forward Current (1/10 Duty Cycle, 0.1ms Pulse Width)	1500mA
Continuous Forward Current	900mA
Derating Linear From 30°C	0.8mA/°C
Reverse Voltage	5V
Operating Temperature Range	-20°C to + 60°C
Storage Temperature Range	-30°C to + 60°C
Lead Soldering Temperature [1.6mm(.063") From Body]	260°C for 5 Seconds

PART NUMBER	REV	PAGE	DATE
WX-P20WW649B10800	R101	2/4	2009-11-27



## SPECIFICATION FOR APPROVAL

### Chromaticity Coordinate Groups



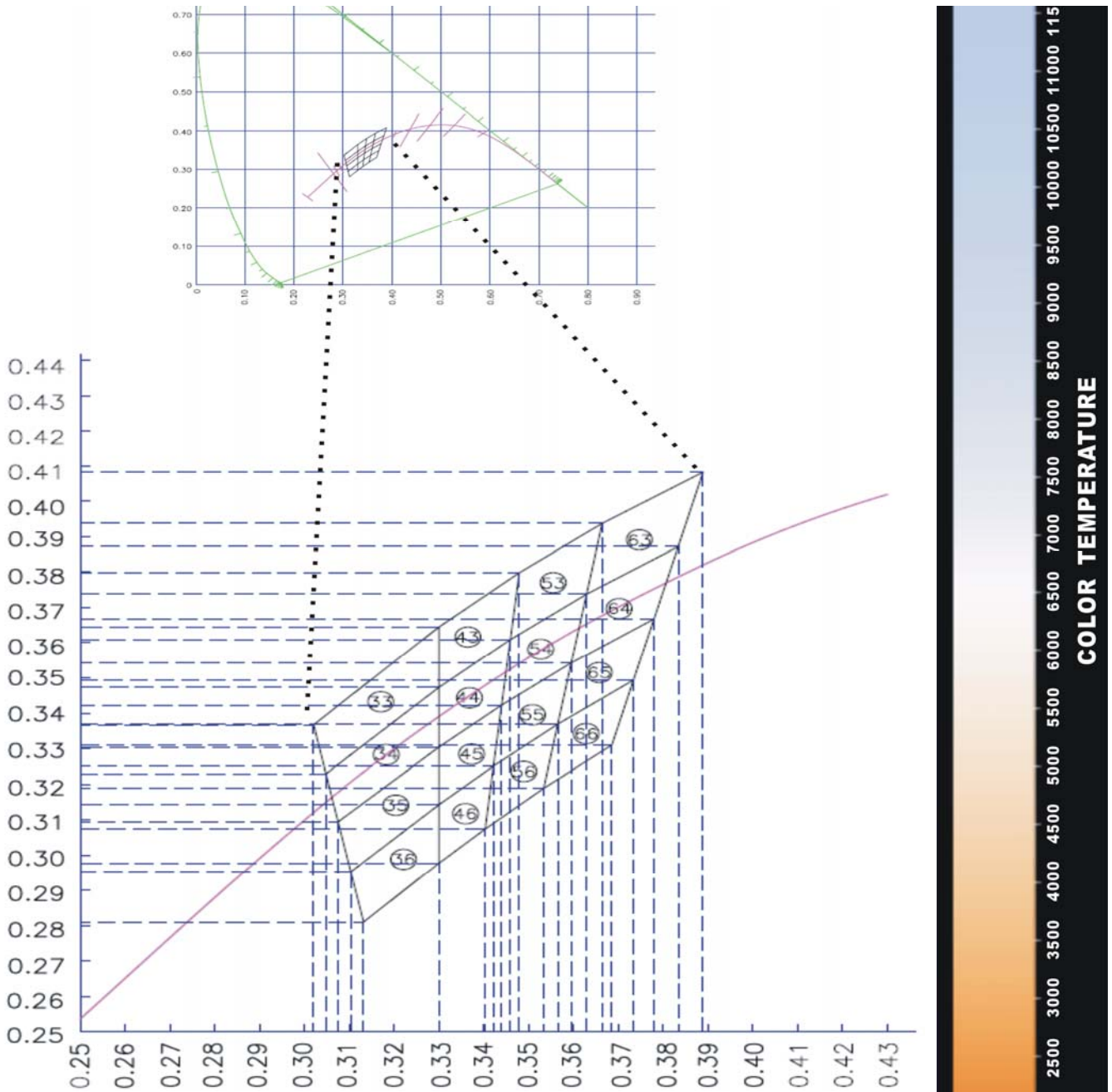

PART NUMBER	REV	PAGE	DATE
WX-P20WW649B10800	R101	3/4	2009-11-27



## SPECIFICATION FOR APPROVAL

### HIGH POWER LED Typical Electro-Optical Characteristics Curves

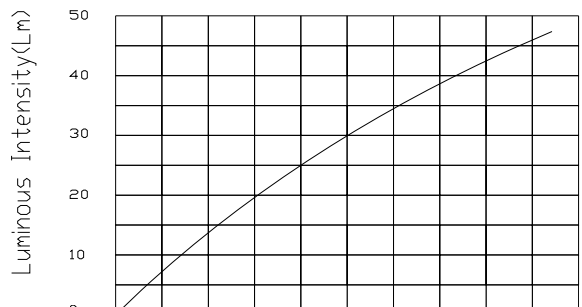
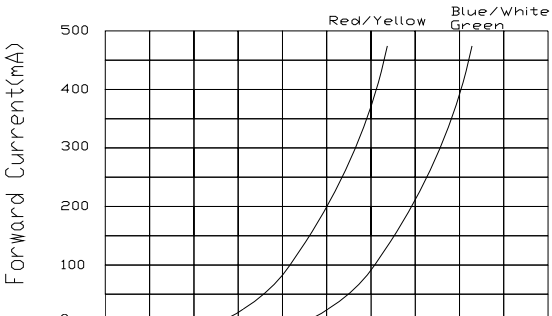

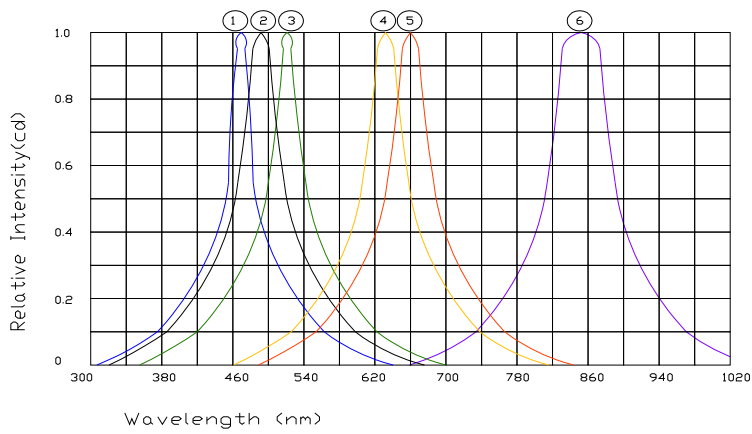
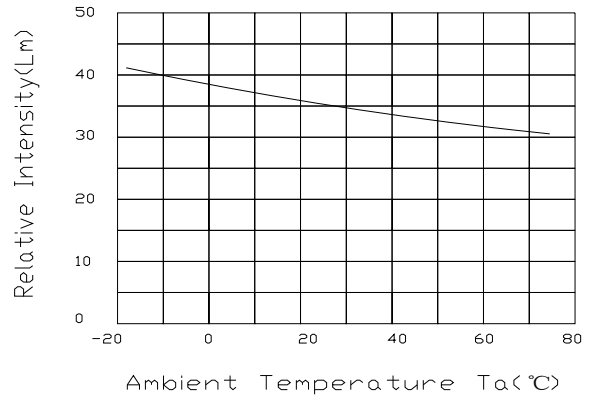
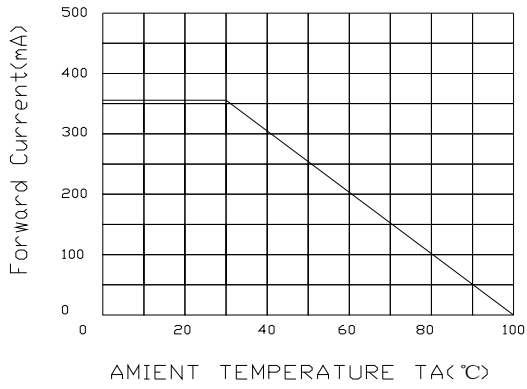
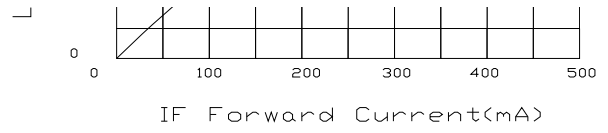
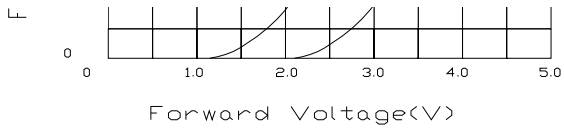

- ① Blue Lamp<InGaN>
- ② White Lamp<InGaN>
- ③ Pure Green Lamp<InGaN>
- ④ Yellow Green Lamp<AlInGaP>
- ⑤ Red Lamp<AlInGaP>
- ⑥ Infrared Lamp<850nm>

PART NUMBER	REV	PAGE	DATE
WX-P20WW649B10800	R101	4/4	2009-11-27